

TRIM INSTALLATION INSTRUCTIONS

Lever Rose

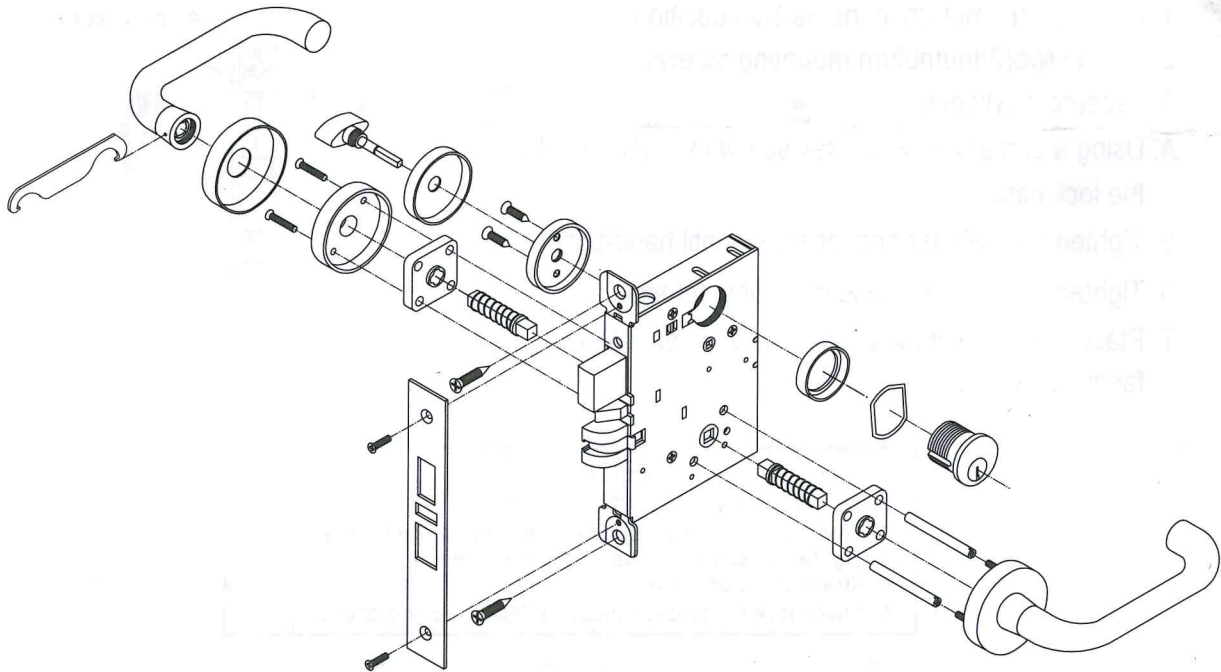

TRIM INSTALLATION INSTRUCTIONS

Lever Escutcheon

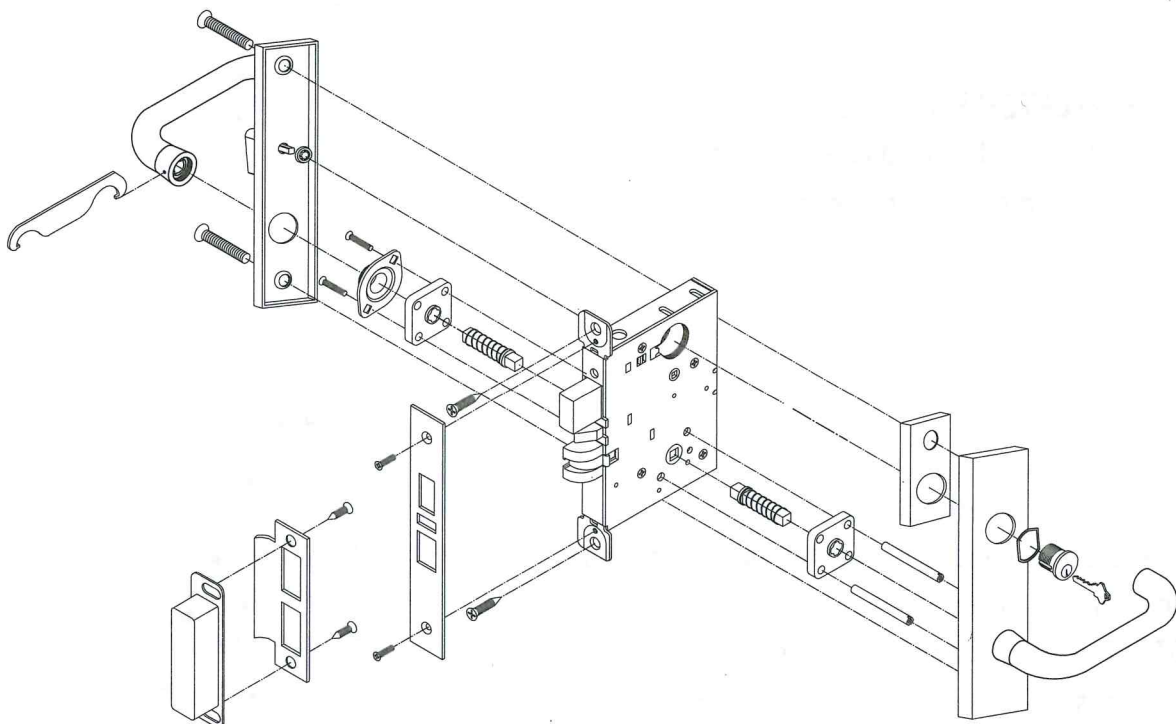

PREPARING THE DOOR

Note: if the strike already exists in the door frame, position lock using strike as reference.

(See strike position on the template)

1. Draw horizontal line on both sides and edge of door at the desired height of lever above floor.
2. Draw vertical center line on door edge.
3. Draw vertical line on each side at the proper backset to align the template.
4. Position template on edge and side of door.
Mark holes ONLY for each side, and top and bottom holes of mortise cavity on door edge.

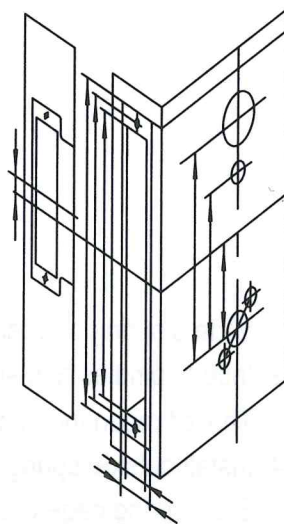

MORTISE THE DOOR (for wood doors)

1. Mortise door for lock case and faceplate per instructions on template.

NOTE: The recess for lock case: $1\frac{3}{32}'' \times 6\frac{5}{8}'' \times 4\frac{9}{16}''$

The recess for faceplate: $1\frac{1}{4}'' \times 8\frac{1}{32}'' \times \frac{1}{4}''$

2. Drill trim holes.

INSTALL THE LOCK CASE

1. Insert the lock case into cavity.
2. Install with the lock handing screw on the INSIDE of the door and leave the mounting screws slightly loose to allow for adjustment.

INSTALL STRIKE

1. Refer to template to determine strike location on jamb.
2. Mark and chisel recess Using template.
Drill screw holes and fasten.

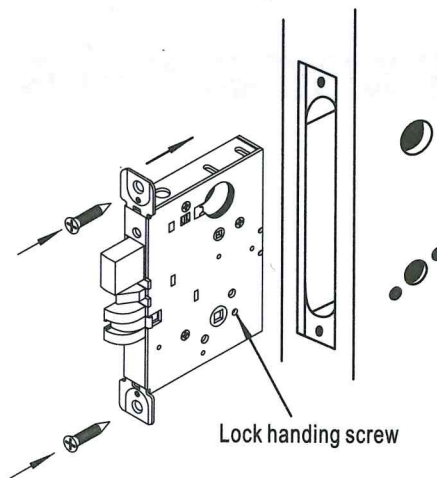

LUBRICATION

1. All locks come from the factory with a lithium based grease. We recommend, however, continued periodic lubrication of internal moving parts with a commercial quality grease. This can add years to the life of the lockset by reducing excessive wear. For more severe environments, lubrication should be applied more frequently.

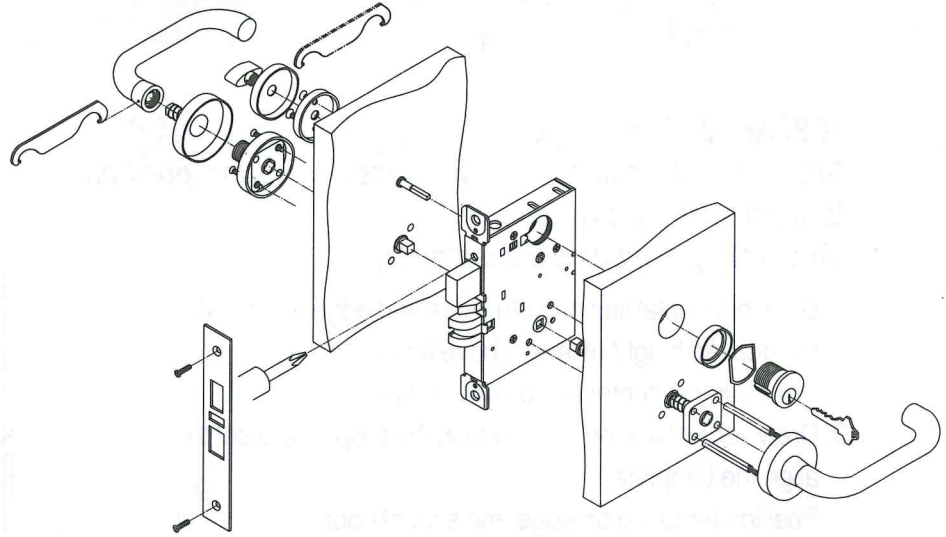

1. Slide a spring over each spindle.
 2. Insert spindles and springs into the lock case
 3. Thread mounting posts onto outside rose.
 4. Install outside spring cage and rose with lever in working position
 5. Slide spring cage over the inside spindle and spring.
 6. Attach mounting plate with two(2) screws and tighten.
 7. Place rose over mounting plate
 8. Install inside lever and tighten bushing with spanner wrench.
- NOTE: When install the spring cage, make sure ARROWS point in the direction of lever rotation

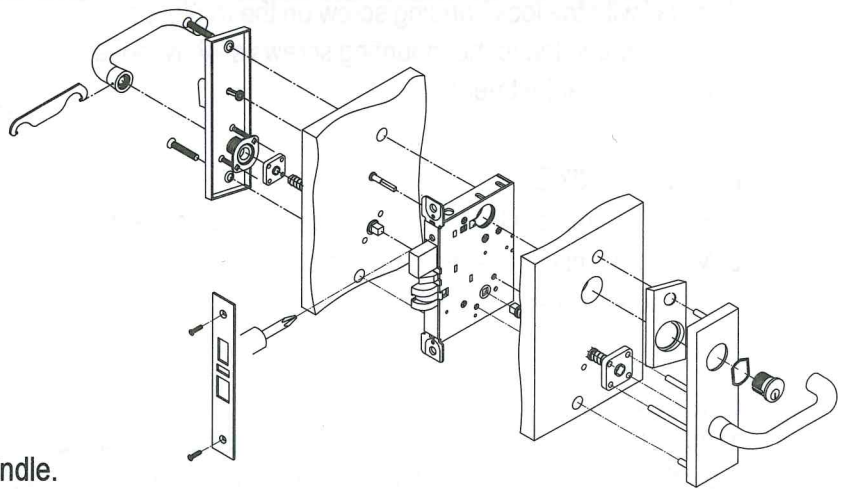

1. Slide a spring over each spindle.
 2. Insert spindles and springs into the lock case
 3. Thread mounting posts onto outside escutcheon.
 4. Install outside spring cage and escutcheon with lever in working position
 5. Slide spring cage over the inside spindle and spring.
 6. Attach mounting plate with two(2) screws and tighten.
 7. Place escutcheon over mounting plate
 8. Install inside lever and tighten bushing with spanner wrench.
- NOTE: When install the spring cage, make sure ARROWS point in the direction of lever rotation

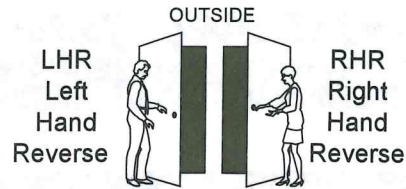
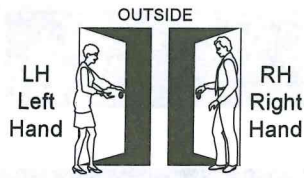

THUMBTURN, CYLINDER & FACEPLATE INSTALLATION

Lever Rose

1. Insert the thumbturn in the vertical position.
2. Fasten two(2)thumbturn mounting screws.
3. Assemble cylinder.
4. Using a partially inserted key, screw the cylinder into the lock case.
5. Tighten the cylinder anchor screw until hand-tight.
6. Tighten the two lock case mounting screws.
7. Place the faceplate in position and fasten with two faceplate screws.

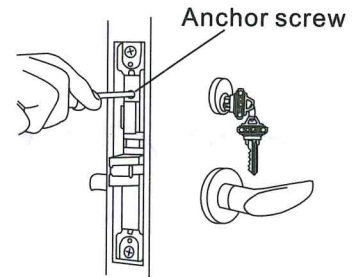

IMPORTANT

1. BE SURE SPINDLES ENGAGE HUBS
2. Test for proper lock operation with turn piece, lever and key.
3. Tighten all screws, including Anchor screw.
4. Attach faceplate cover.
5. Check lock for proper function BEFORE closing door.

TO CHANGE HANDING

1. Change LATCH HANDING.

- a. Pull anti-friction tongue and latchbolt away from lock case.
- b. Rotate latchbolt 180° degrees.

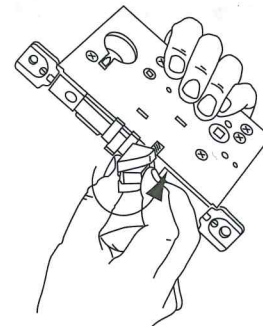

Pull and rotate

2. Change LOCK HANDING SCREW

- a. Remove lock handing screw from side of lock case.
- b. Install lock handing screw on other side of lock case.

NOTE: The lock handing screw must always be on the INSIDE of the door for proper operation of the lock.

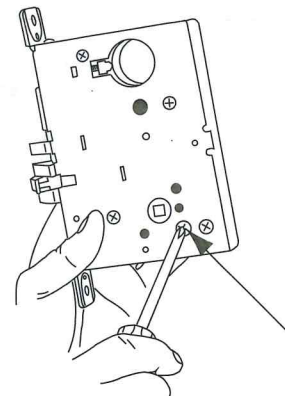

Lock handing screw